

FRONT ELEVATION

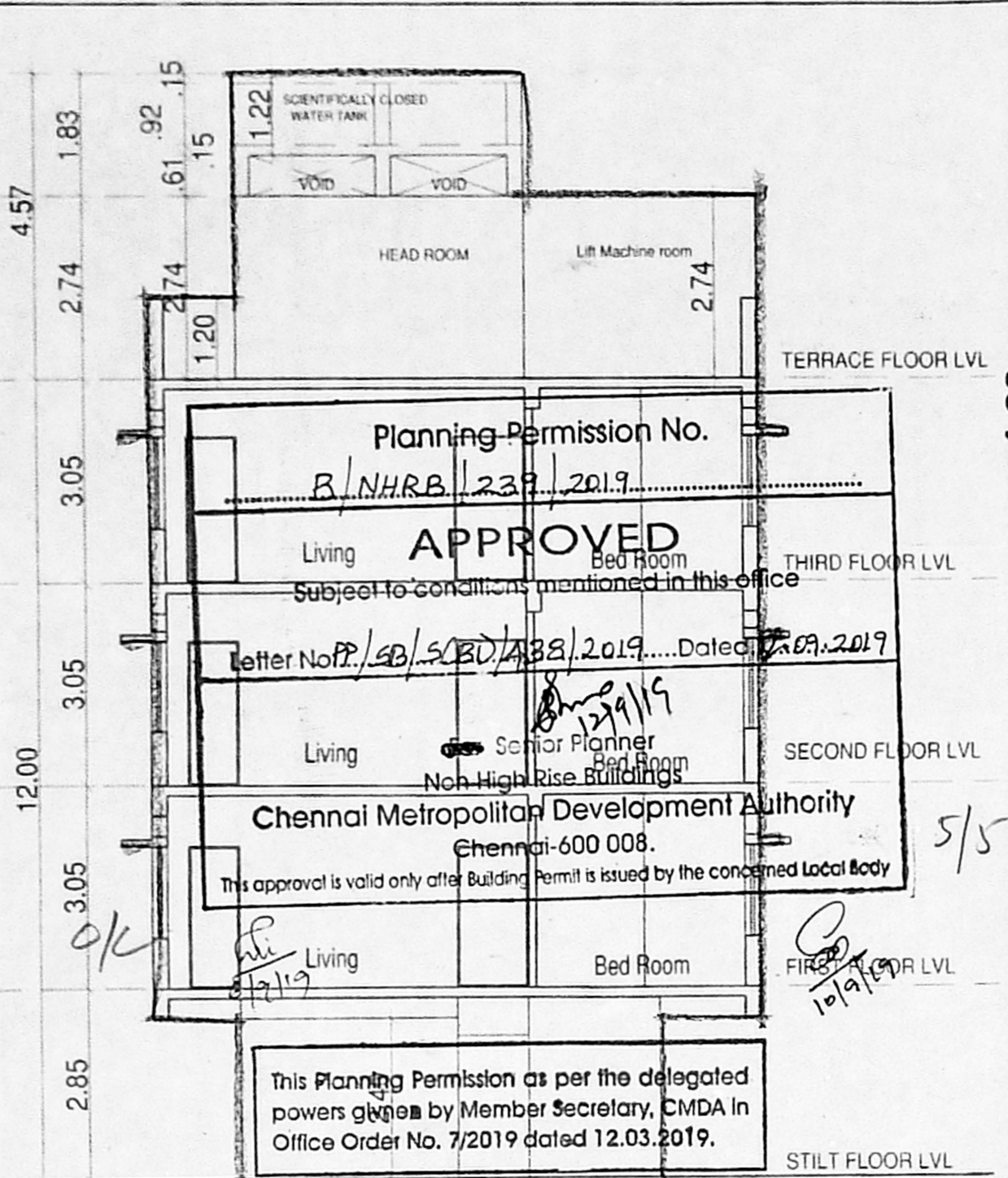

SECTION "AA"

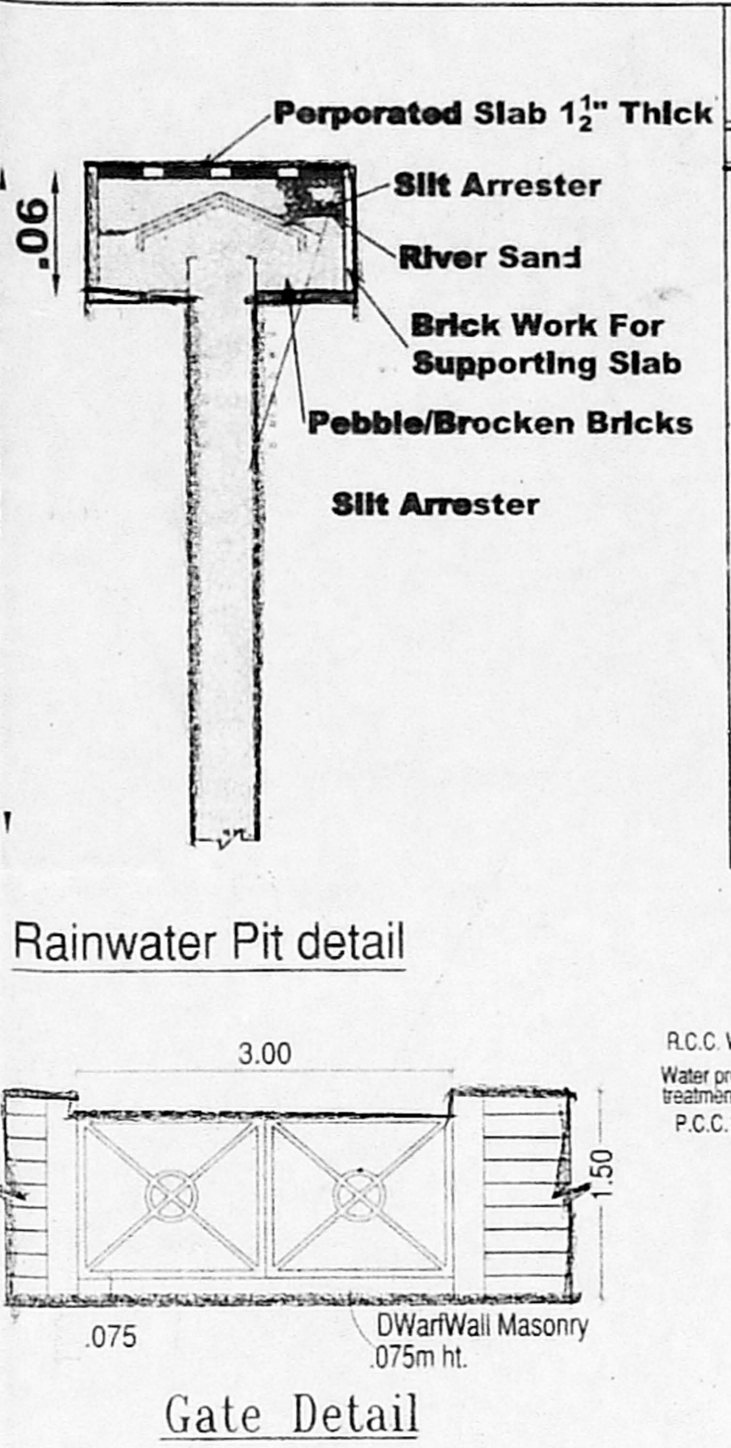

Rainwater Pit detail

Gate Detail

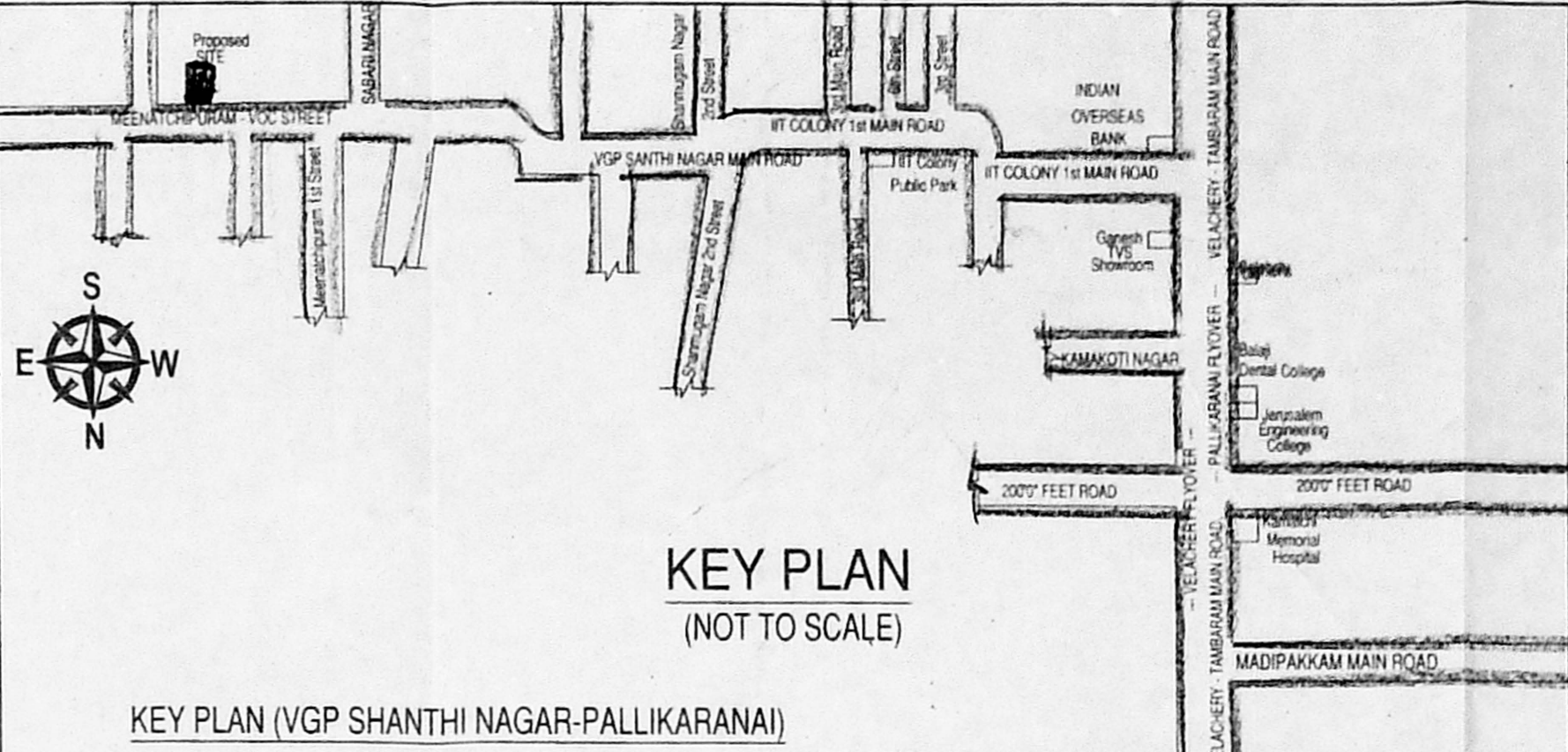

KEY PLAN (NOT TO SCALE)

KEY PLAN (VGP SHANTHI NAGAR-PALLIKARANAI)

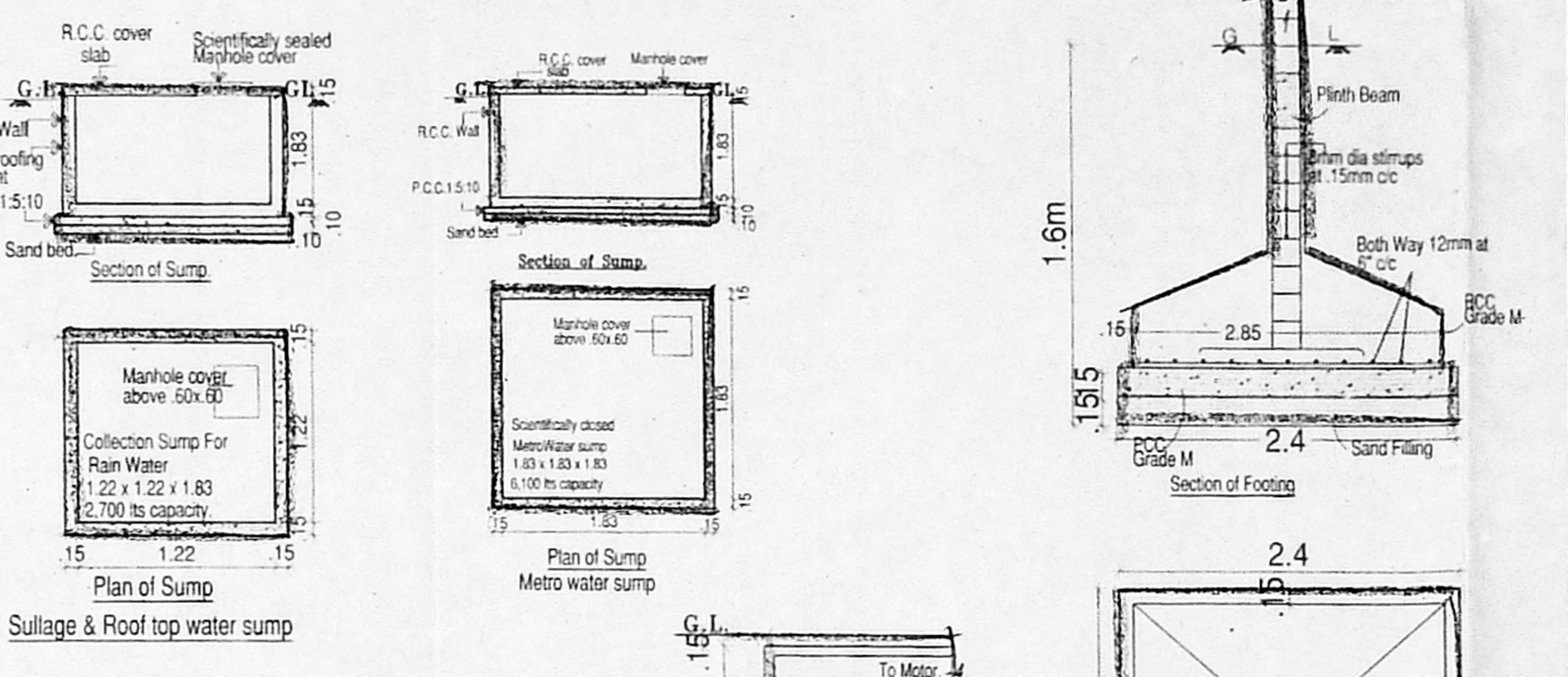

Section of Sump

Section of Sump

Manhole cover above 50x50

Manhole cover above 50x50

Plan of Sump

Plan of Sump

Sullage & Roof top water sump

Metro water sump

Section of Footing

Column Foundation detail
Plan of Footing

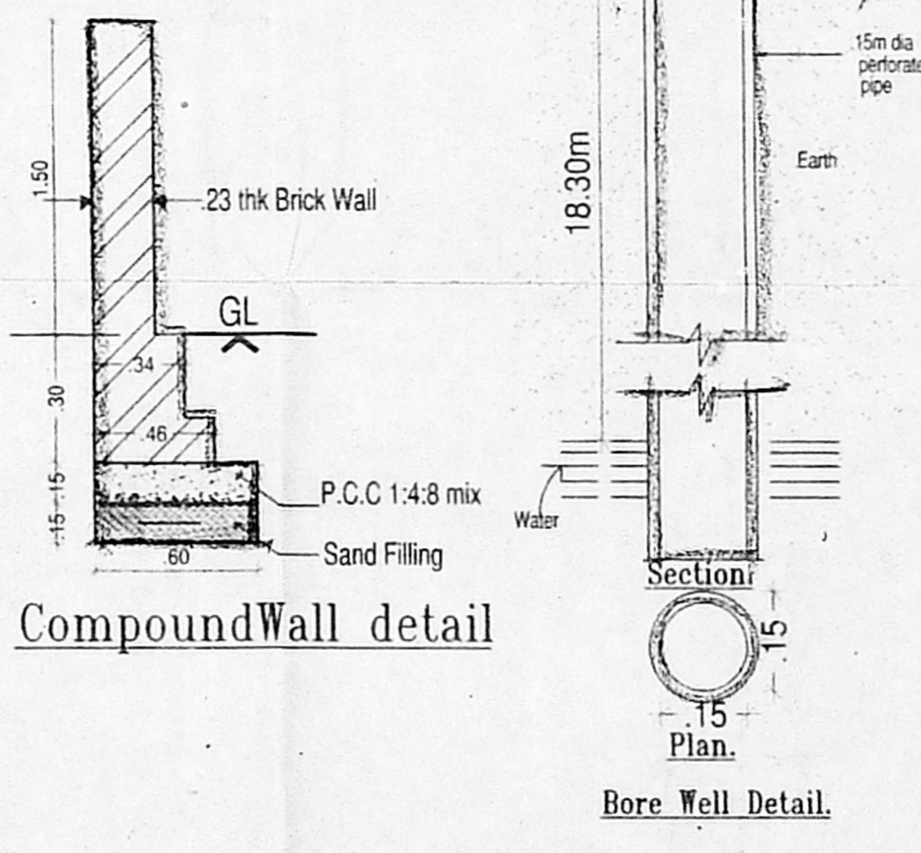

Compound Wall detail

Bore Well Detail

DWartWall Masonry detail

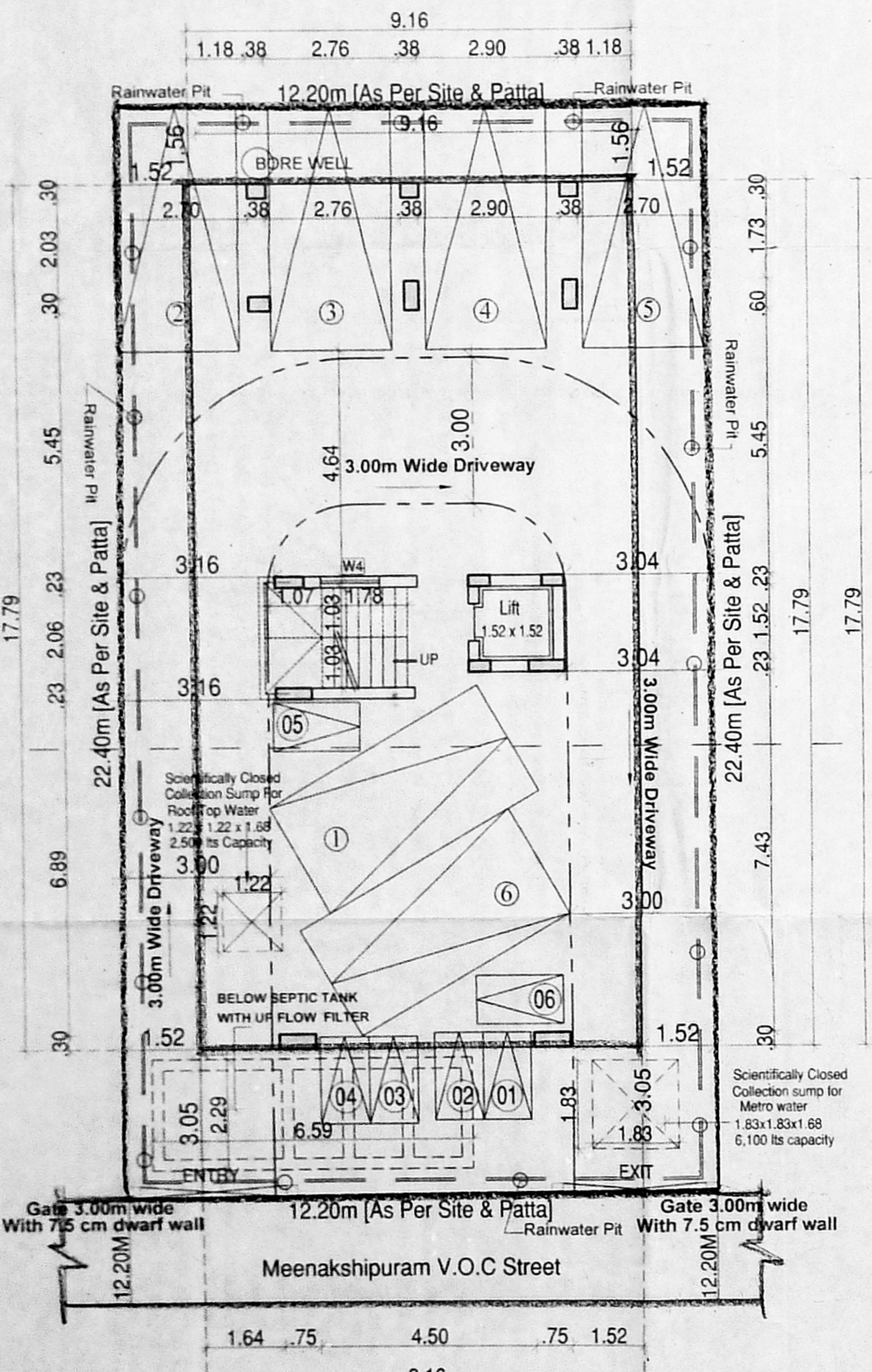

SITE CUM STILT FLOOR PLAN

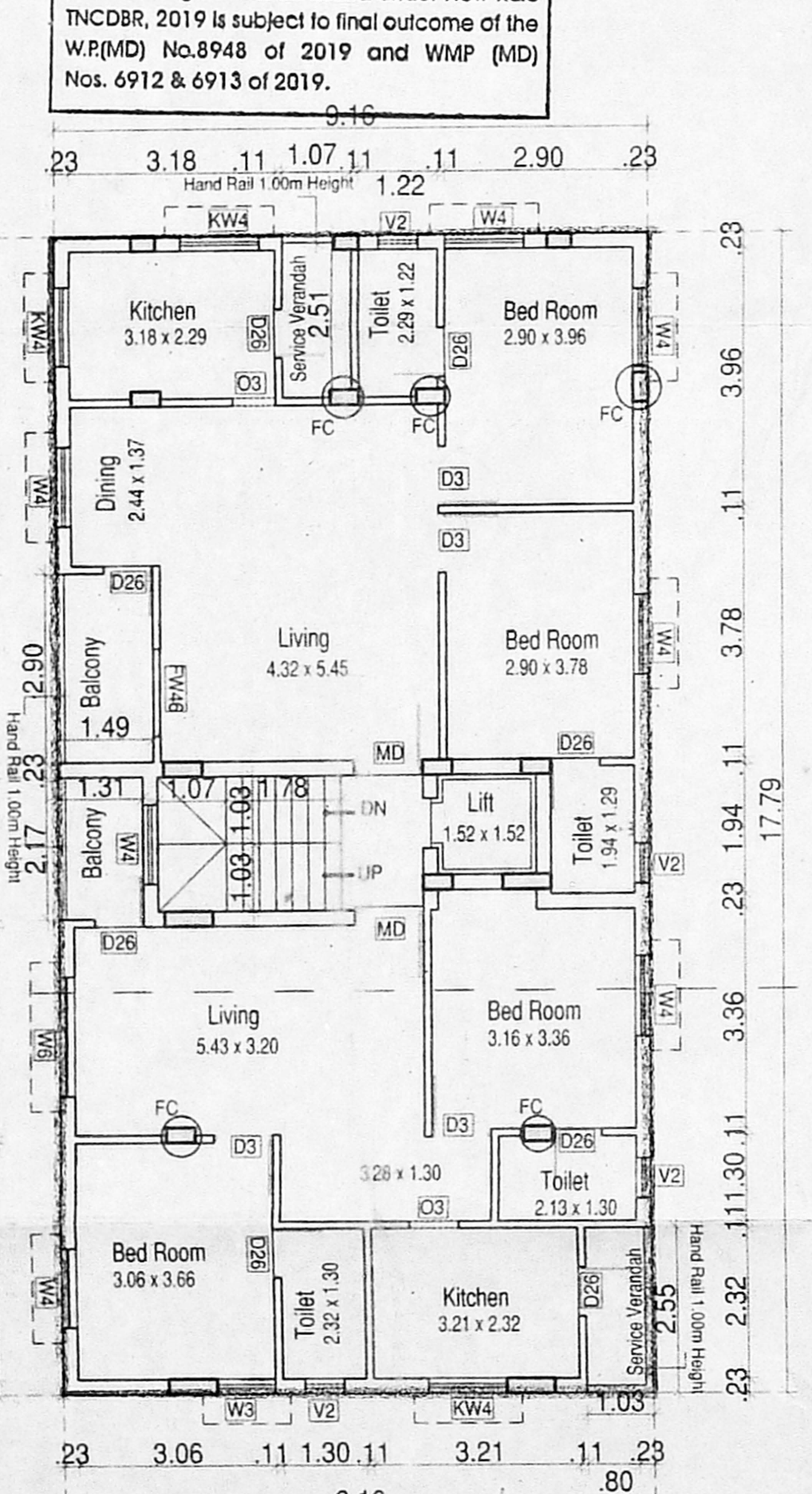

TYPICAL FLOOR PLAN
1st, 2nd & 3rd Floor

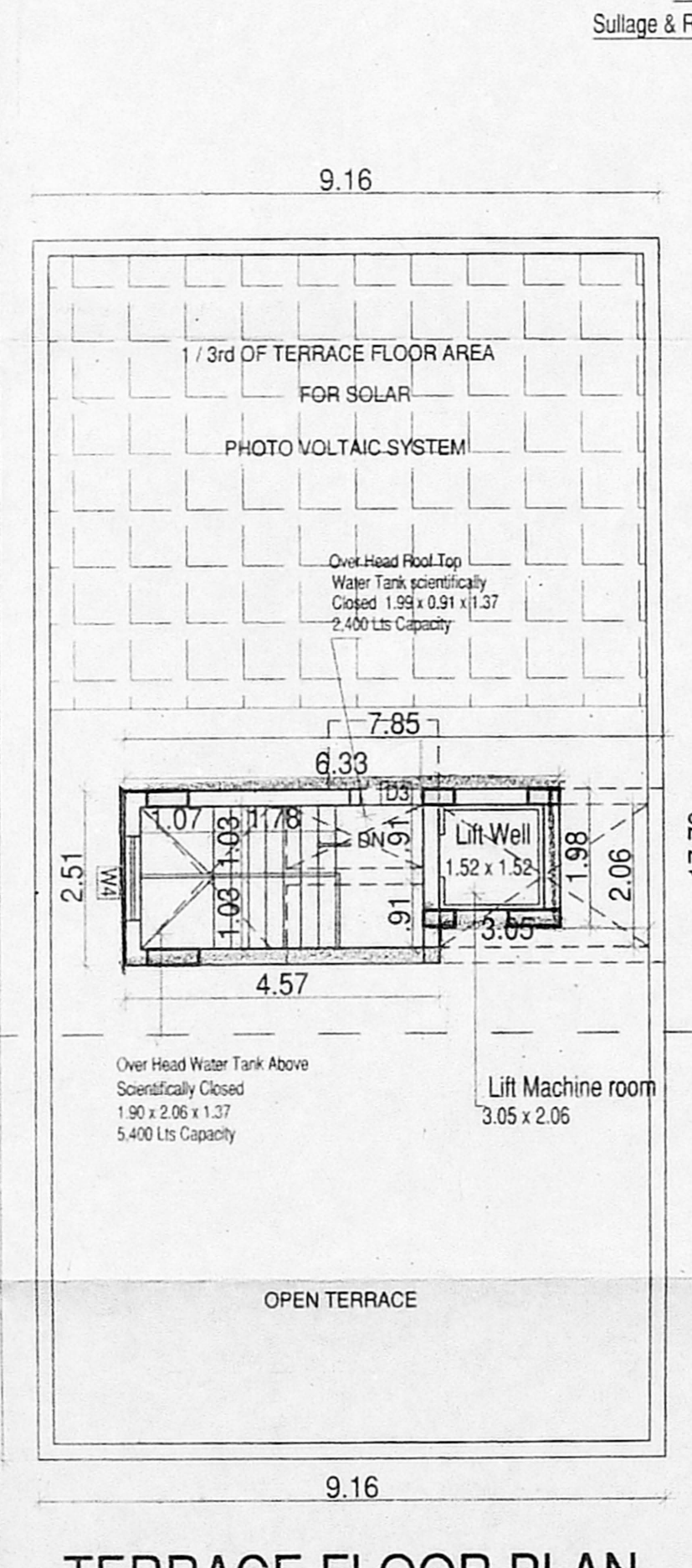

TERRACE FLOOR PLAN

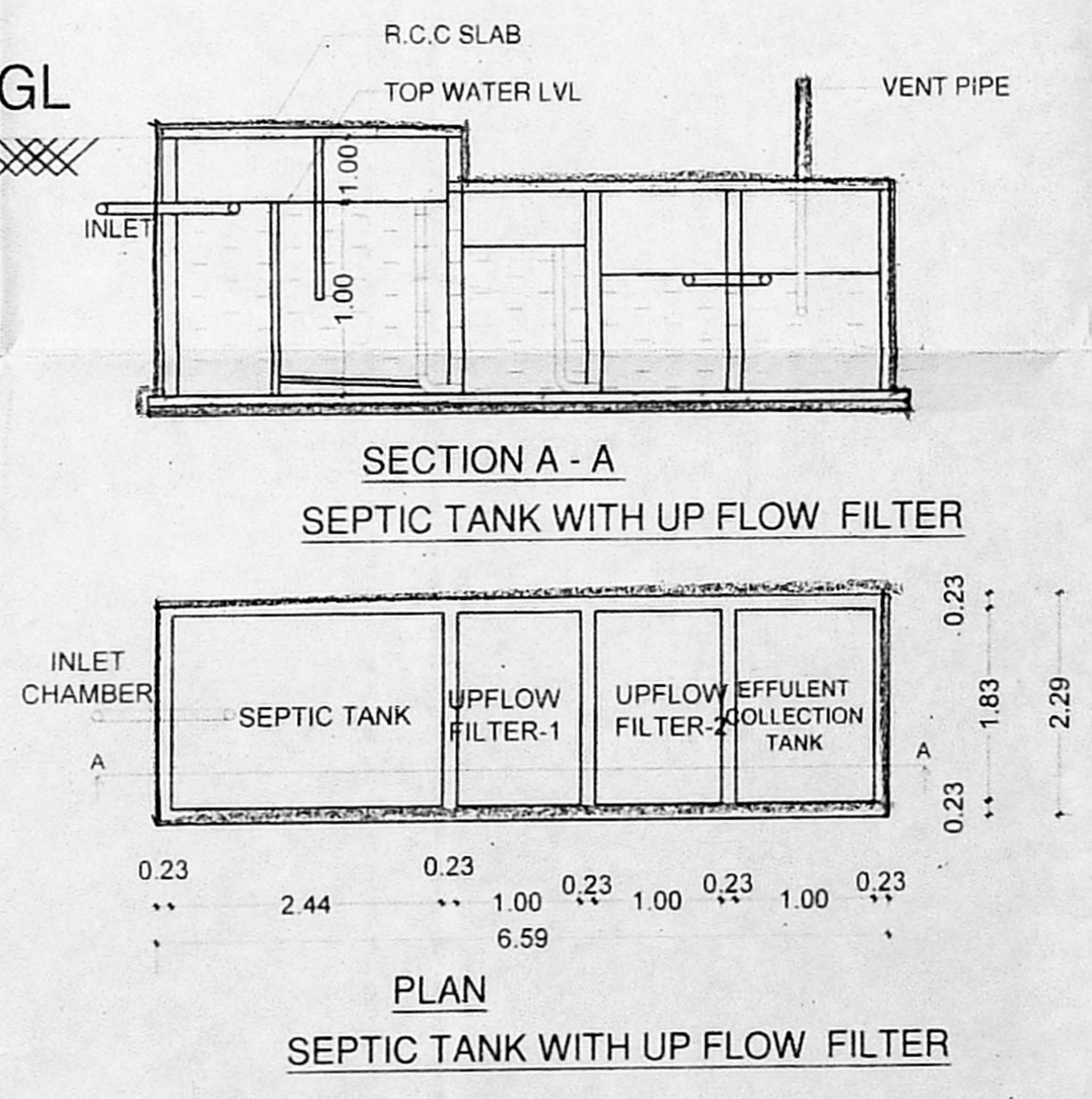

SECTION A - A
SEPTIC TANK WITH UP FLOW FILTER

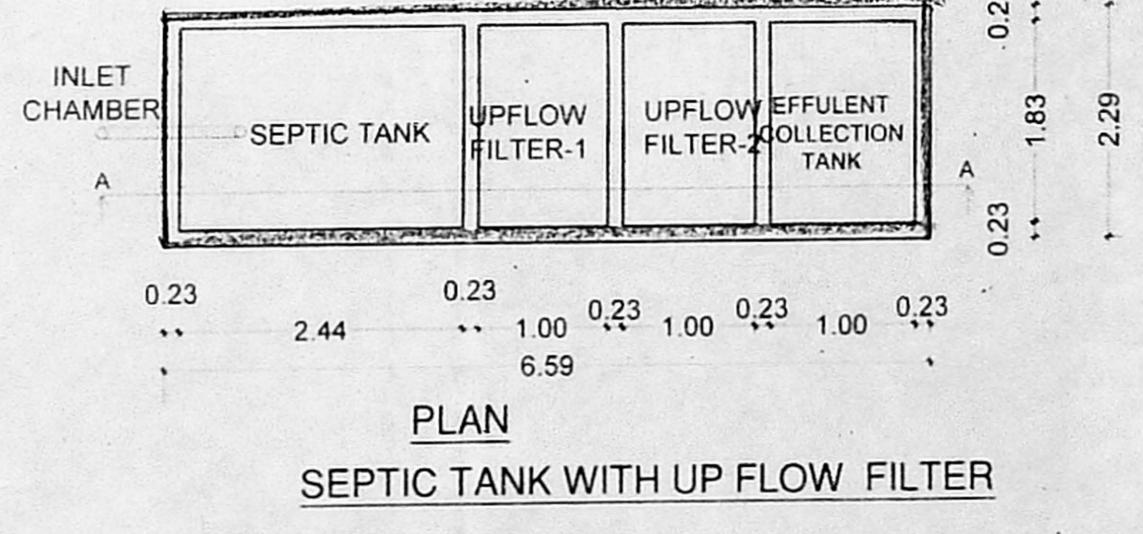

PLAN
SEPTIC TANK WITH UP FLOW FILTER

PLAN SHOWING THE PROPOSED CONSTRUCTION OF STILT + 3 FLOORS RESIDENTIAL BUILDING AT PLOT NO - 62, MEENAKSHIPURAM V.O.C STREET, VGP SHANTHI NAGAR PART - III, COMPRISED IN S.NO-623 / 1 (AS PER DOCUMENT), 623/4 (AS PER PATTI), PALLIKARANAI VILLAGE, TAMBARAM TALUK, KANCHEEPURAM DISTRICT, GREATER CHENNAI CORPORATION.

ZONE- XIV DIVISION-189

Specification:
 Foundation : RCC Column
 R.C.C Work : For Lintel, etc.
 Super Structure : B.W in C.M
 Flooring : Vitrified Tiles
 Joinery : Best Indian Country
 Finishes : Exterior & interior
 Weathering course : Brick jolly lime conc. below the weathering tiles

Schedule of Joineries:
 MD 1.07 X 2.13 Panelled Door
 D3 0.91 X 2.13 Panelled Door
 D26 0.76 X 2.13 Panelled Door
 W6 1.83 X 1.37 Window
 W4 1.22 X 1.37 Window
 W3 0.90 X 1.37 Window
 FW46 1.33 X 1.98 French Window
 KW4 1.22 X 1.07 Kitchen Window
 V2 0.70 X 0.90 Ventilator

AREA STATEMENT

PLOT AREA AS PER PATTI - 250.00 Sq.m
 PLOT AREA AS PER DOC. - 271.27 Sq.m

FLOOR	F.S.I	F.S.I Achieved - 1.955
FIRST FLOOR	162.92	Car Parking Provided - 06 Nos
SECOND FLOOR	162.92	T.W Parking Provided - 06 Nos
THIRD FLOOR	162.92	
TOTAL	488.76	

ALL DIMENSIONS ARE IN METRES
 SCALE 1: 100
 LEGEND:
 PROPOSED SHOWN IN
 BOUNDARY SHOWN IN
 ROAD SHOWN IN

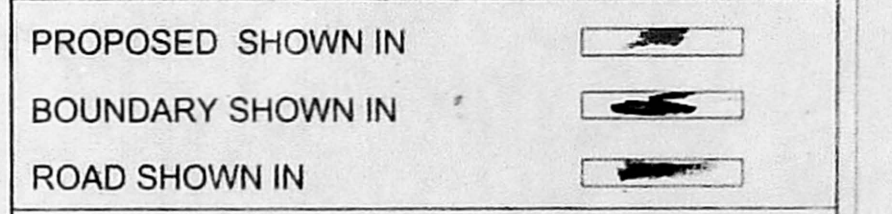

OWNER'S SIGNATURE

P.Muthukumar, R.Arch.
 Regd No:COA / 2012 / 54824
 #14/40, Shanmugam Road,
 West Tambaram, Chennai-45,
 Cell:9941167812, 22266737

LICENSED SURVEYOR SIGNATURE